

FEATURES

- 7 years warranty based on Ta45°C (24/7)
- EPD (Environmental Product Datasheet)
- Registered in NMD (Nationale Milieu Database, in progress)
- Wide standard range of drivers (No dim, Triac, Dali, Casambi)
- CLO (Constant Light Output, in development) & NFC (for adjustable lumen outputs) available.
- High Lm/W (5500Lm 151Lm/W)
- UGR <16 (max 3200Lm)
UGR <18 (max 5650Lm)
- Long lifetime of 111.000 hrs (TM21 L80B50)
- Delivered with self-locking AMP plug for easy connection with the driver
- Extra strong housing material to prevent bending
- Environmental packaging (10 pcs per carton)
- Engineered in the Netherlands
- ENEC approved

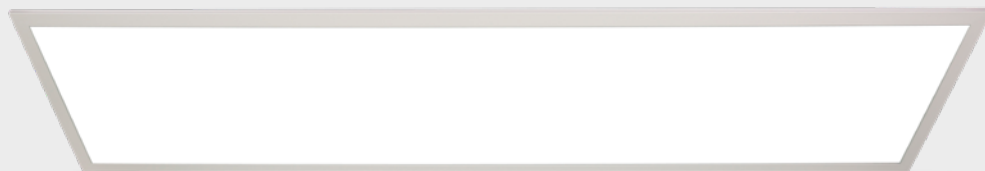

LED Panel B 1195x295 (CRI93)

SPECIFICATIONS

Beam angle	84°
Color	White 9016
Fixture material	Frame - Aluminium / UGR Prisma PS
LEDs	Jufei 2835
CRI	93
IK rate	IK03
IP rate	IP44
Operating temperature	-20°C / +45°C
Safety marks	EN60598 / EN62031 / EN62471
Colour consistency	MacAdam step 3
LV Plug	Yes
Safety class	III
Warranty	7 years (within the European Union and the countries of the Free Trade Association for products delivered after 1 May 2015)
Energy class	These products contain a light source of energy efficiency class D

This luminaire contains built-in LED lamps. There are no exchangeable parts inside the luminaire. EU 874/2012

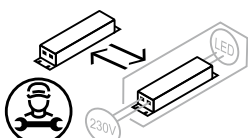

IP44

LED PANEL B 1195X295

Max 1050 mA - CRI93

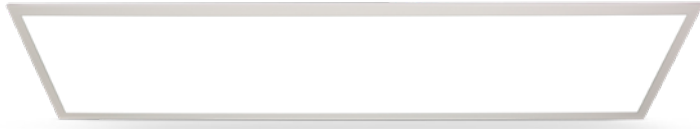

ITEM SPECIFICATIONS FOR STANDARD CURRENT SETTINGS

Description	Item code	Input	Vf	W	Lm	Lm/W	CRI (typ.)	UGR	Pf	Ripple	Inrush current	B-16A Fuse
LED Panel B 1195x295 max 5400Lm CRI93 3000K	321L03MW63E2	max 1050mA	34,6	36,3	5400	149	93	17,9	x	x	x	x
LED Panel B 1195x295 max 5500Lm CRI93 4000K	321L03MW64E2	max 1050mA	34,6	36,3	5500	151	93	18,2	x	x	x	x

Description	Safety class	Energy class	Expected Lifetime			Reported Lifetime*		
			L70B10	L80B10	L90B10	L70B10	L80B10	L90B10
LED Panel B 1195x295	III	D	186.000 hrs	118.000 hrs	57.000 hrs	>102.000 hrs	>102.000 hrs	57.000 hrs

Description	Weight	Packaging	Dimension bulk packaging	Pallet 120x80x210cm	40Ft without pallets	20Ft without pallets
LED Panel B 1195x295	1560 gr	Bulk per 10 pcs	1230x410x340mm	90 pcs	5000 pcs	2000 pcs

CHOOSE YOUR LV LUMEN OUTPUT

	mA	Vf	W	Lumen Output		Lumen / Watt		UGR		CRI	Advised PSU			
				3000K	4000K	3000K	4000K	3000K	4000K		No dim	Dali	Triac	Casambi
Special request	250	31,6	7,9	1350	1375	171	174	13,2	13,5	93	CC36W150-900	CC36W150-900	x	142047
Special request	300	31,8	9,5	1600	1625	168	170	13,8	14,1	93	145192	CC36W150-900	x	142047
Special request	350	32,0	11,2	1875	1900	167	170	14,4	14,6	93	145192	CC36W150-900	EC25CA-E1ZHP	142047
Special request	450	32,4	14,6	2250	2300	154	158	14,3	15,4	93	145192	CC36W150-900	x	142047
Special request	500	32,6	16,3	2625	2675	161	164	15,5	15,8	93	145192	CC36W150-900	EC25CA-E1ZHP	142047
Special request	550	32,8	18,0	2900	2950	161	164	15,8	16,1	93	145192	CC36W150-900	x	142047
Special request	600	33,0	19,8	3175	3225	160	163	16,1	16,4	93	145192	CC36W150-900	x	142047
Standard	650	33,2	21,6	3450	3500	160	162	16,4	16,7	93	145192	CC36W150-900	x	142047
Special request	700**	33,4	23,4	3725	3800	159	163	16,6	16,9	93	145192	CC36W150-900	EC25CA-E1ZHP	142047
Standard	800	33,7	27,0	4275	4350	159	161	17,1	17,3	93	145192	CC36W150-900	x	142047
Special request	850	33,9	28,8	4500	4575	156	159	17,5	17,5	93	145192	CC36W150-900	x	142047
Special request	1000	34,4	34,4	5175	5250	150	153	17,8	18,1	93	145192	CC44W300-1050	x	142047
Standard	1050	34,6	36,3	5400	5500	149	151	17,9	18,2	93	145192	CC44W300-1050	x	142047

All values are measured at 230V (+/- 7%). *Based on 17.000 hrs of LM80 testing at 120mA per LED and a Tc55°C. **Standard 700 mA only for Triac.

DIMENSIONS

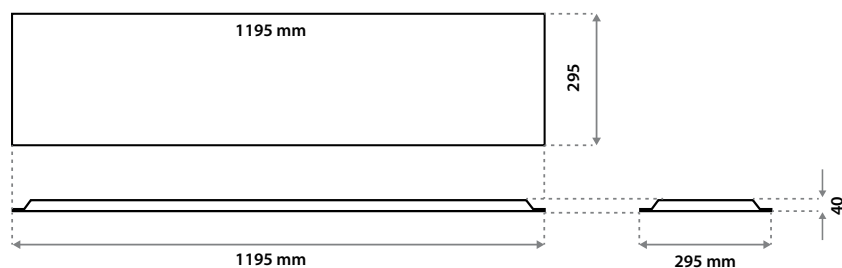

PSU



PSU 40W No dim TCI 145192
129x43x23 mm
Exp. lifespan 100.000 hrs



PSU 36W Dali KGP CC36W150-900 NFC*
163x30x21 mm
Exp. lifespan 100.000 hrs



PSU 25W Triac Eldoled EC25CA-EIZHP
151x42x28 mm
Exp. lifespan 100.000 hrs



PSU 38W Casambi TCI 142047 NFC*
147x44x22 mm
Exp. lifespan 100.000 hrs



**PSU 44W Dali
KGP CC44W300-1050**
97x43x30 mm
Exp. lifespan 100.000 hrs

Item specifications (PSU)

Driver types	Supplier name	Item code	Input	W	Max mA	Max Vf	Pf	Eff.	Inrush current	B-16A Fuse
PSU 40W 650mA No dim TCI	145192	05TR03MLMA00	220-240V AC/DC	40W	300-1050	43	0,99	>90%	7A 13µsec	50 pcs
PSU 36W 650mA Dali KGP	CC36W150-900	05QB03MLMA00	220-240V AC/DC	36W	150-900	40	>0,95	88%	8,5A 16µS	59 pcs
PSU 25W 700mA Triac Eldoled	EC25CA-EIZHP	05PZ03MLMA00	220-240V AC/DC	25W	350-700	36	0,95	85%	8,4A 544µS	85 pcs
PSU 38W 650mA Casambi TCI	142047	05TU03MLMA00	220-240V AC/DC	38W	150-1050	54	0,95	>89%	5A 50µsec	50 pcs
PSU 40W 800mA No dim TCI	145192	05TS03MLMA00	220-240V AC/DC	40W	300-1050	42	0,99	>90%	7A 13µsec	50 pcs
PSU 36W 800mA Dali KGP	CC36W150-900	05PX03MLMA00	220-240V AC/DC	36W	150-900	40	>0,95	88%	8,5A 16µS	59 pcs
PSU 38W 800mA Casambi TCI	142047	05TV03MLMA00	220-240V AC/DC	38W	150-1050	46	0,95	>89%	5A 50µsec	50 pcs
PSU 40W 1050mA No dim TCI	145192	05TT03MLMA00	220-240V AC/DC	40W	300-1050	38	0,99	>90%	7A 13µsec	50 pcs
PSU 44W 1050mA Dali KGP	CC44W300-1050	05Q603MLMA00	220-240V AC/DC	44W	300-1050	45	>0,95	88%	<9,4A/16µS	53 pcs
PSU 38W 1050mA Casambi TCI	142047	05TW03MLMA00	220-240V AC/DC	38W	150-1050	36	0,95	>89%	5A 50µsec	50 pcs

All values are measured at 230V (+/- 7%).

*NFC INSTRUCTION VIDEO



KGP CLO in development
TCI NFC & CLO in development

LV CABLE (for customer PSU, not recommended)

Description	Item code
LV Cable 0,15m AMP	6H5203BLIB02

No warranty when used with own PSU.

PLUG & PLAY CABLE SYSTEM 3/5P

(A)
GST18 Plug &
Play Solutions
(Assembled
to driver)

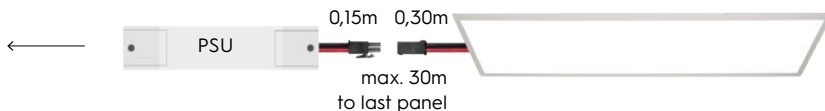

FEATURES

- Professional 16A Plug & Play system
- 3 or 5 wire system
- Widely spread in lighting market



Item specifications (accessories)

Description	Class	Length	Item code
(A1) Euro plug incl. cable	II	2.0 m	015203BL1200
(A2) Schuko plug incl. cable	I	1.5 m	1C5203BLA000
(A3) UK plug incl. cable	II	2.0 m	0A5203BL1200
(A4) 3P GST18 male incl. cable 2x0.75mm²	II	0.3 m	455203BL0000
(A4) 3P GST18 male incl. cable 2x0.75mm²	II	3.0 m	455203BL1500
(A4) 3P GST18 male incl. cable 3x0.75mm²	I	0.3 m	4A5203BL0000
(A4) 3P GST18 male incl. cable 3x0.75mm²	I	3.0 m	4A5203BL1500
(A5) 5P GST18 male 1-10V/Dali incl. cable 4x0,75mm²	II	0,3 m	655203BL0000
(A5) 5P GST18 male 1-10V/Dali incl. cable 4x0,75mm²	II	3,0 m	655203BL1500

Description	Class	Length	Item code
(A6) BST14i male Dali incl. cable	III	0.5 m	095203BL0000
(A6) BST14i male Dali incl. cable	III	3.0 m	095203BL1500
(A7) 3P GST18 T-splitter male incl. cable	II	0.2 m	459203BL0000
(A7) 3P GST18 T-splitter male incl. cable	I	0.2 m	4A9203BL0000
(A8) 5P GST18 T-splitter male 1-10V/Dali	I / II	x	659203BU0000
(A9) BST14i T-splitter male 1-10V/Dali incl. cable	III	0,2 m	099203BL0000

DISTRIBUTOR SYSTEM 2P

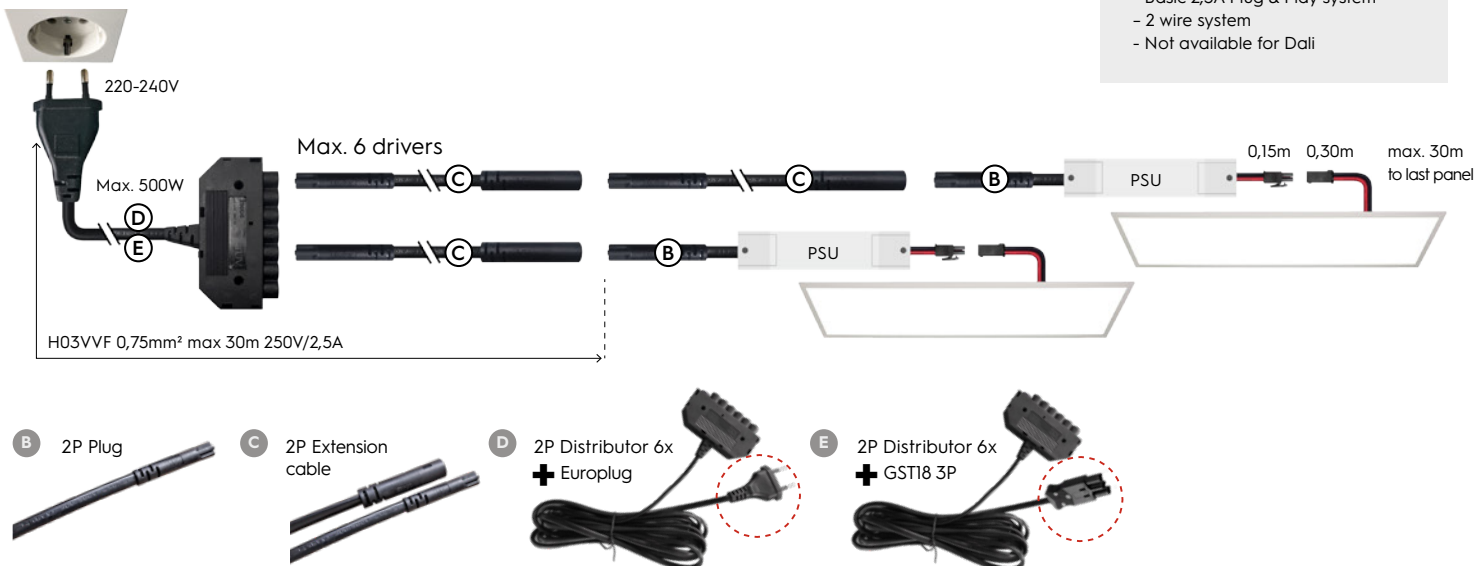

FEATURES

- Basic 2,5A Plug & Play system
- 2 wire system
- Not available for Dali

Item specifications (accessories)

Description	Specification	Class	Length	Item code
(B) 2P Plug 0,15m *	HV 0,15m male (0,75mm²)	II	0,15 m	6J5203BL1B02
(C) 2P Extension cable	HV Ø7,6mm 2m m/f (0,75mm²)	II	2.0 m	6F5203BL1202
(D) 2P Distributor 6x + Europlug	HV Ø7,6mm 6x + cable 3m 2,5A	II	3,0 m	665203BL2502
(E) 2P Distributor 6x + GST18 3P	HV Ø7,6mm 6x + cable 3m 2,5A	II	3,0 m	665203BL1502

*Assembled to driver, not for Dali drivers.